

Bromley Road

ASHLEY DOWN

APPROXIMATE FLOOR AREA
79.5 SQM / 855 SQFT

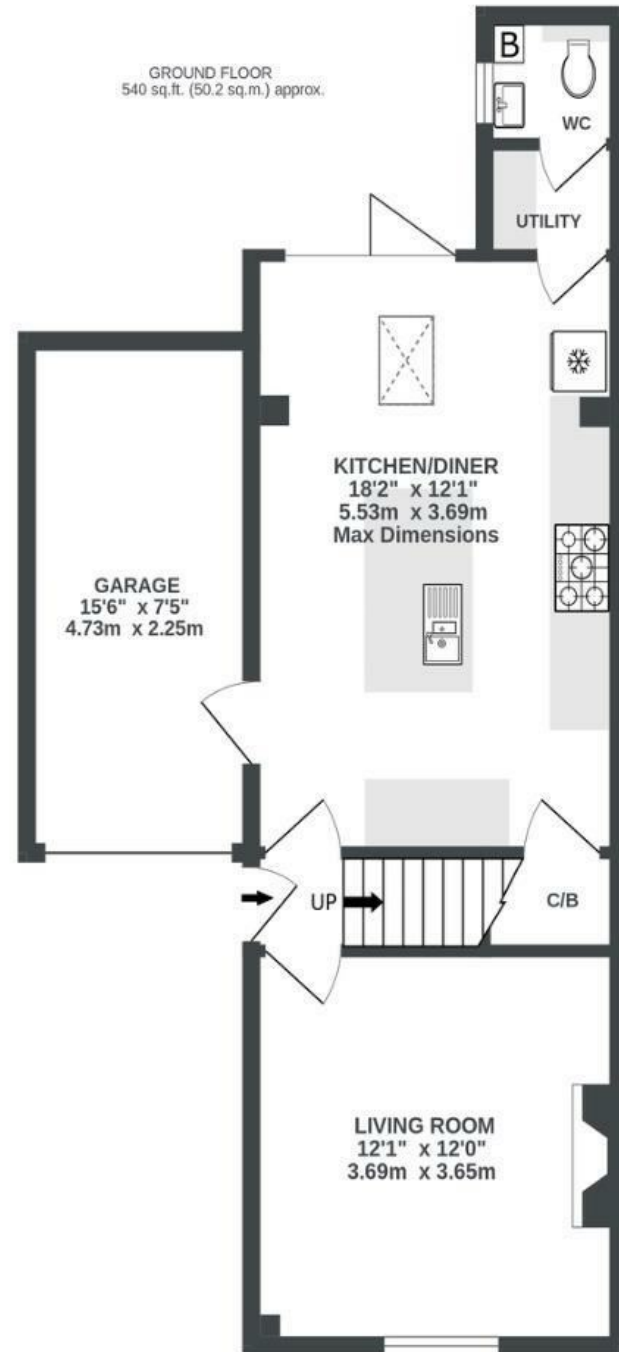

1ST FLOOR
315 sq.ft. (29.3 sq.m.) approx.

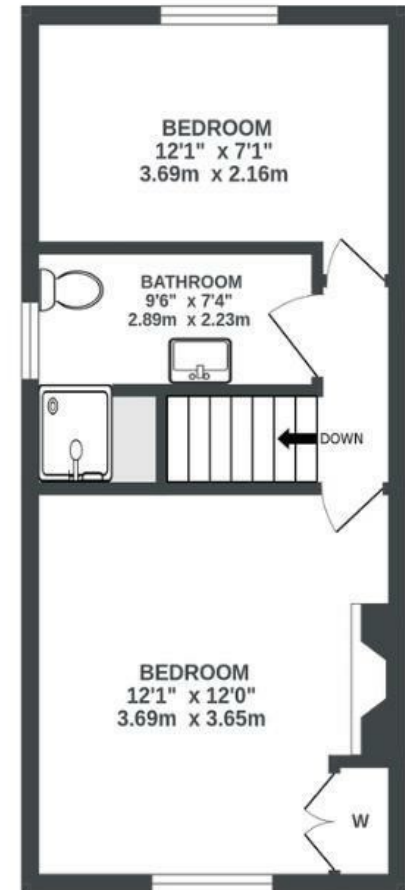

Illustrations are for reference purposes only, measurements are approximate, not to scale.

Boardwalk

Bromley Road

ASHLEY DOWN, BRISTOL

£

£450,000

zzz

2 Bedrooms



BS7 9JA



2 Bathrooms

"We've really enjoyed living in a house with such character, yet being so close to Gloucester Road and all it has to offer. Off-street parking and a garage are a real game changer in this location! The local bakery has become a firm favourite, as have our walks and runs into Stoke Park and out to Snuff Mills."

